

## DEADBREAK SEPARABLE CONNECTORS

### ELBOW CONNECTOR – MSCE/EC-250-A



#### Description

Separable elbow connector with mechanical conductor contact. For polymeric medium voltage (MV) cables up to 12.7/22 (24) kV. Rating 250 A – Interface A.

#### Utilisation

- For connection to transformers, switch gear units, motors, etc.
- Indoor and outdoor installation. The connector is entirely protected by a watertight conductive envelope connected to earth.
- Continuous 250 A rms
- Overload 300 A rms (8 hours per 24-hour period).
- Dead-break operated.
- Voltage detection through an integrated capacitive voltage divider.

#### Cables

- Single core polymeric insulation (PE, XLPE, EPR).
- Copper or aluminium conductor, solid or stranded.
- Semi-conducting screen either extruded or taped.
- Metallic screen of copper tape, copper wires or polylam type.
- Insulation voltage up to 12.7/22 (24) kV.
- Conductor sizes: 25 to 95 mm<sup>2</sup>.  
For cables with other sizes, please contact us.

#### Standards

Generally meets the requirements of CENELEC HD 629.1 S2, IEC 60502-4, C 33-051, C 33-001.

Interfaces: CENELEC EN 50180 & EN 50181.

Mechanical conductor contact: IEC 61238-1 class A.

#### Packing

Supplied as a kit of three single connectors containing all the necessary components. Shipping weight and volume (approx) of kit: 3 kg/0.006 m<sup>3</sup>.



#### Other products

- Associated products such as bushing FMBOm-250, FMBOh-250 and accessories for separable connectors 250A, interface A.
- Separable straight connector MSCS/EC-250-A.

#### Installation features

- For voltage class 24 kV, one product reference only allows to cover cross from 25 mm<sup>2</sup> to 95 mm<sup>2</sup>, copper or aluminium conductor.
- No need for special tools, no heating, taping or filling.
- Vertical, angled or inverted position.
- No minimum distance between phases.
- Individual clamping by stainless steel brace.
- The three phases may also be locked together and to the equipment by use of metallic rings (supplied on request, separately or already fitted onto the molded groove).
- Energizing may take place immediately after the connector is plugged on its mating bushing, dead-end plug.
- An unplugged connector must never be energized.

Technical information subject to change without notice.

All sizes and values without tolerances are reference values. Specifications are for product as supplied by Prysmian Group; any modification or alteration afterwards of product may give different result. The information contained within this document must not be copied, reprinted or reproduced in any form, either wholly or in part, without the written consent of Prysmian Group. The information is believed to be correct at the time of issue. Prysmian Group reserves the right to amend this specification without prior notice. This specification is not contractually valid unless specifically authorised by Prysmian Group.



## SELECTION GUIDE – MSCE/EC-250-A

Voltage $U_m$	Diameter over insulation (mm)		Conductor size (mm <sup>2</sup> )* <sup>1</sup>		Kit reference
	Min.	Max.	Min.	Max.	
12 kV	11.8	23.2	25	95	MSCE/EC-250-A-12-25/95* <sup>2</sup>
17 kV	11.8	23.2	25	95	MSCE/EC-250-A-17-25/95* <sup>2</sup>
24 kV	17.2	25.0	25	95	MSCE/EC-250-A-24-25/95

\*<sup>1</sup> For guidance only. \*<sup>2</sup> Models with adapters.

1. Select the kit corresponding to the insulation voltage  $U_m$  in kV and to the diameter over cable insulation.
2. Select suitable earthing device.

**Example:**

1x50 mm<sup>2</sup>, 22 kV polymeric cable, diameter over insulation 21.5 mm, with copper wire screen, aluminium conductor:  
MSCE/EC-250-A-24-T3-25/95.

## EARTHING DEVICE

Type of metallic screen of cable	Reference
Polyam	T1
Copper tape	T2
Copper wires	T3

## INTERFACE FOR SEPARABLE CONNECTORS – TYPE A

According to CENELEC EN 50180 & EN 50181. Medium Voltage (MV)

Insulator voltage:	24 kV
Continuous current:	250 A
D1	Bore: Ø 7.9 mm, depth 32 mm
D2	Ø 31 mm
D3	Ø 32.5 mm
D4	Ø 48.5 mm
L1	48 mm
Utilisation	250 A Sliding contact 12 & 24 kV

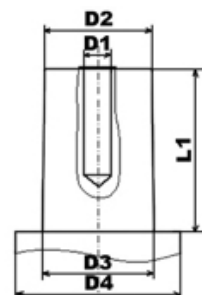

Technical information subject to change without notice.

All sizes and values without tolerances are reference values. Specifications are for product as supplied by Prysmian Group; any modification or alteration afterwards of product may give different result. The information contained within this document must not be copied, reprinted or reproduced in any form, either wholly or in part, without the written consent of Prysmian Group. The information is believed to be correct at the time of issue. Prysmian Group reserves the right to amend this specification without prior notice. This specification is not contractually valid unless specifically authorised by Prysmian Group.

